

Site Location Map
1 : 1000

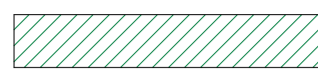

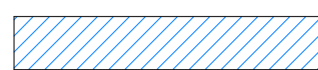
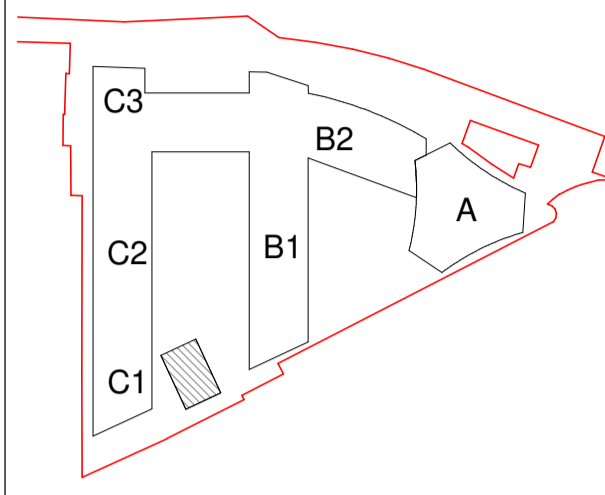
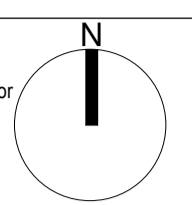

DCC Transport 
DCC Parks 

Notes:
DO NOT SCALE FROM THIS DRAWING. USE FIGURED DIMENSIONS
IN ALL CASES. VERIFY DIMENSIONS ON SITE AND REPORT ANY
DISCREPANCIES TO THE ARCHITECTS IMMEDIATELY. THIS
DRAWING TO BE READ IN CONJUNCTION WITH THE ARCHITECTS
SPECIFICATION. © THIS DRAWING IS COPYRIGHT AND MAY ONLY
BE REPRODUCED WITH THE ARCHITECTS PERMISSION.

OSI License Number - AR 0052219
Projection / Spatial Reference:
Projection: IRENE196_ish_Transverse_Mercator
Centre Point Coordinates:
X,Y= 713657.3699,734403.2446
Reference Index:
Map Series / Map Sheets
1:1,000 | 3263-02
1:1,000 | 3263-06
1:1,000 | 3263-07
1:1,000 | 3263-03
Vertical Datum:
MAULIN HEAD

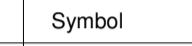

Planning Application Legend

Description	Symbol
SITE BOUNDARY LINE	
LANDS WITHIN OWNERSHIP OF DCC	
EXTENT OF PROPOSED DEVELOPMENT / WORKS	
CRITICAL DIMENSIONS TO SITE BOUNDARY OR ADJACENT STRUCTURES	

P01 | 18/20/23 | WM | Issued for Planning

Rev	Date	DRN	Description



Client Details:
Ruirside Developments Ltd.

Project Details:
PGATE
42A Parkgate Street, Dublin 8

Drawing Title:
Site Location Map 01

Job No P18-107D-A	Date 18/20/23	Scale@A1 1:1000
Status Planning	Drawn By: J Basquel	
Purpose Planning Permission	Checked By: L Wynne	
Drawing Number PGATE-RAU-ZZ-DR-A-MPL-30001	Revision P01	