

PERMITTED

CRIMINAL COURTS

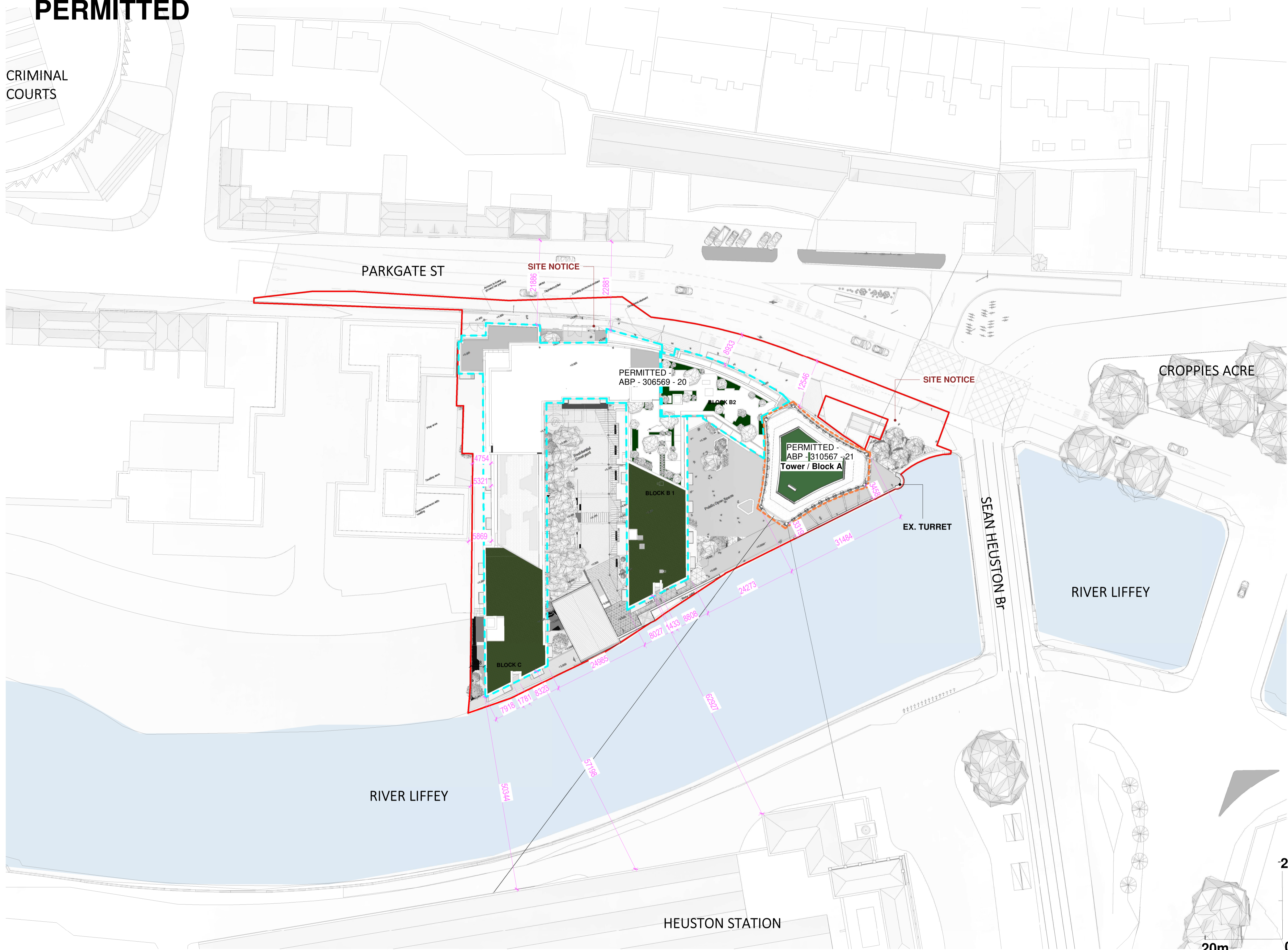

Notes:
DO NOT SCALE FROM THIS DRAWING. USE FIGURED DIMENSIONS IN ALL CASES. VERIFY DIMENSIONS ON SITE AND REPORT ANY DISCREPANCIES TO THE ARCHITECTS IMMEDIATELY. THIS DRAWING TO BE READ IN CONJUNCTION WITH THE ARCHITECTS SPECIFICATION. © THIS DRAWING IS COPYRIGHT AND MAY ONLY BE REPRODUCED WITH THE ARCHITECTS PERMISSION.

OSI License Number - AR 005219
Projection / Spatial Reference:
Projection: IRENE196_msh_Transverse_Mercator
Centre Point Coordinates:
X,Y= 713657.3699,734403.2446
Reference Index:
Map Series / Map Sheets
1:1,000 | 3263-02
1:1,000 | 3263-08
1:1,000 | 3263-07
1:1,000 | 3263-03
Vertical Datum:
MALIN HEAD

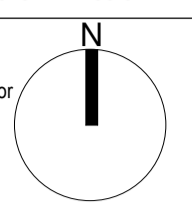

PLANNING LEGEND

SYMBOL	DESCRIPTION
[Red line]	SITE BOUNDARY LINE
[Blue line]	OWNERSHIP LINE
[Grey area]	EXISTING STRUCTURES
[Yellow area]	WAYLEAVE / RIGHT OF WAY
[Green triangle]	RESIDENTIAL ENTRANCE
[Orange triangle]	PUBLIC ENTRANCE

P01 | 18/10/23 | WM | Issued for Planning

Rev	Date	DRN	Description

reddyarchitecture +urbanism

Reddy Architecture + Urbanism
Dartly Road
Dublin 6, D06 Y0E3.
T: +353 (0)1 4987000
W: www.reddyarchitecture.com
E: info@reddyarchitecture.com

Client Details:
Ruirside Developments Ltd.

Project Details:
PGATE
42A Parkgate Street, Dublin 8

Drawing Title:
Permitted Site Layout Plan

Job No P18-107D-A	Date 18/10/23	Scale@A1 1:500
Status For Information	Drawn By: J Basquel	
Purpose Planning Permission	Checked By: L Wynne	
Drawing Number PGATE-RAU-ZZ-ZZ-DR-A-MPL-30001	Revision P01	